

Handleiding aanmelden iPad in MDM Dominicus College

Start safari op en vul in adresbalk **zuludesk.com/manage/enroll/** in en klik op **Ga**

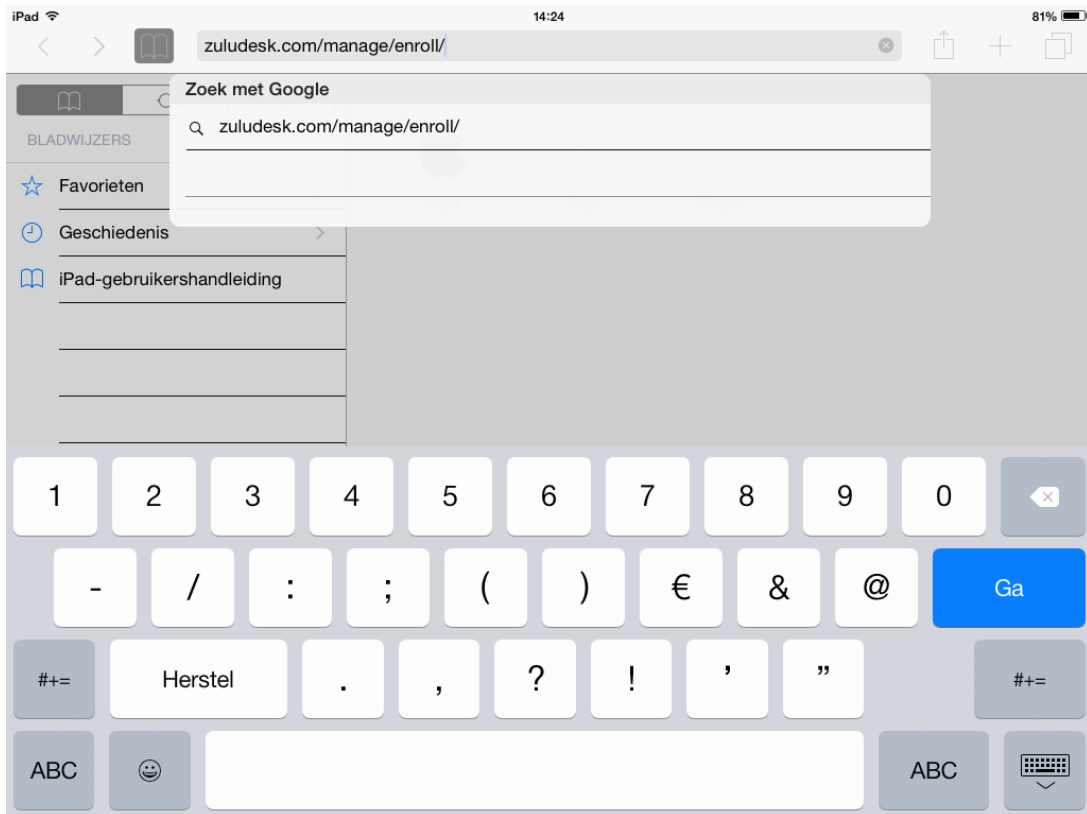

Vul Network ID **352780** in en klik op **Enroll**

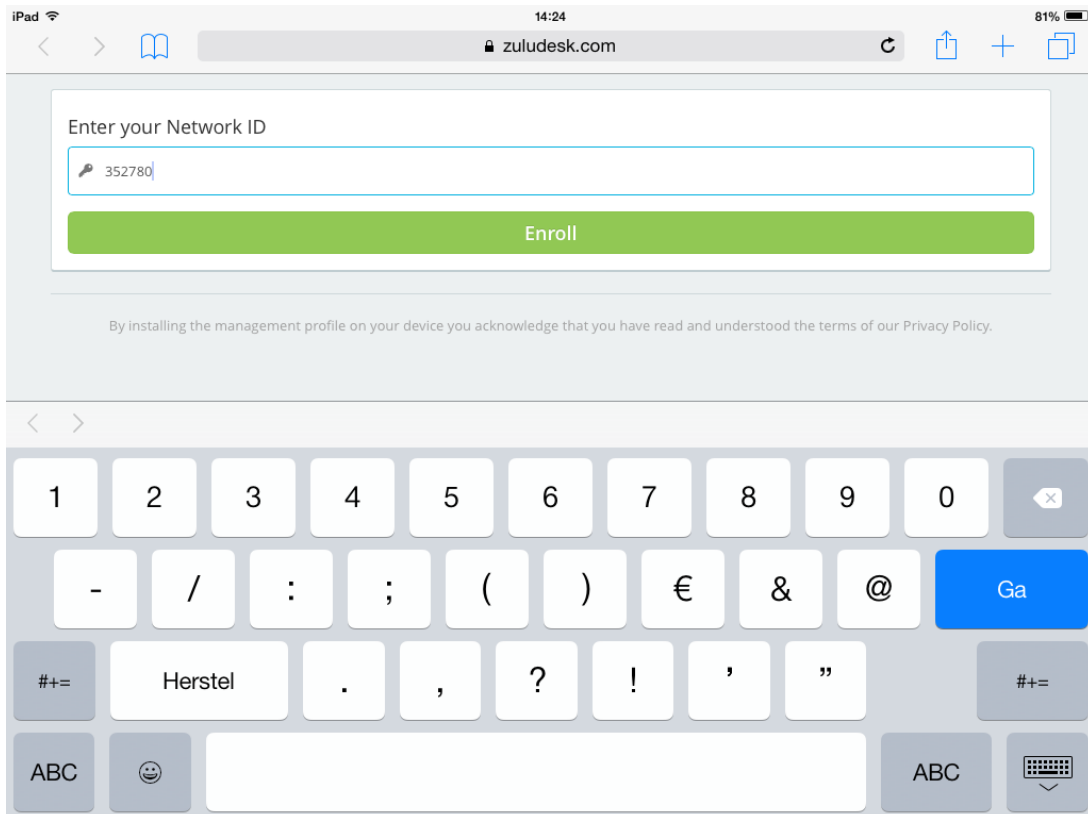

Vul gebruikersnaam (leerlingnummer) en wachtwoord (begeleidende brief) in en klik op **Log in**

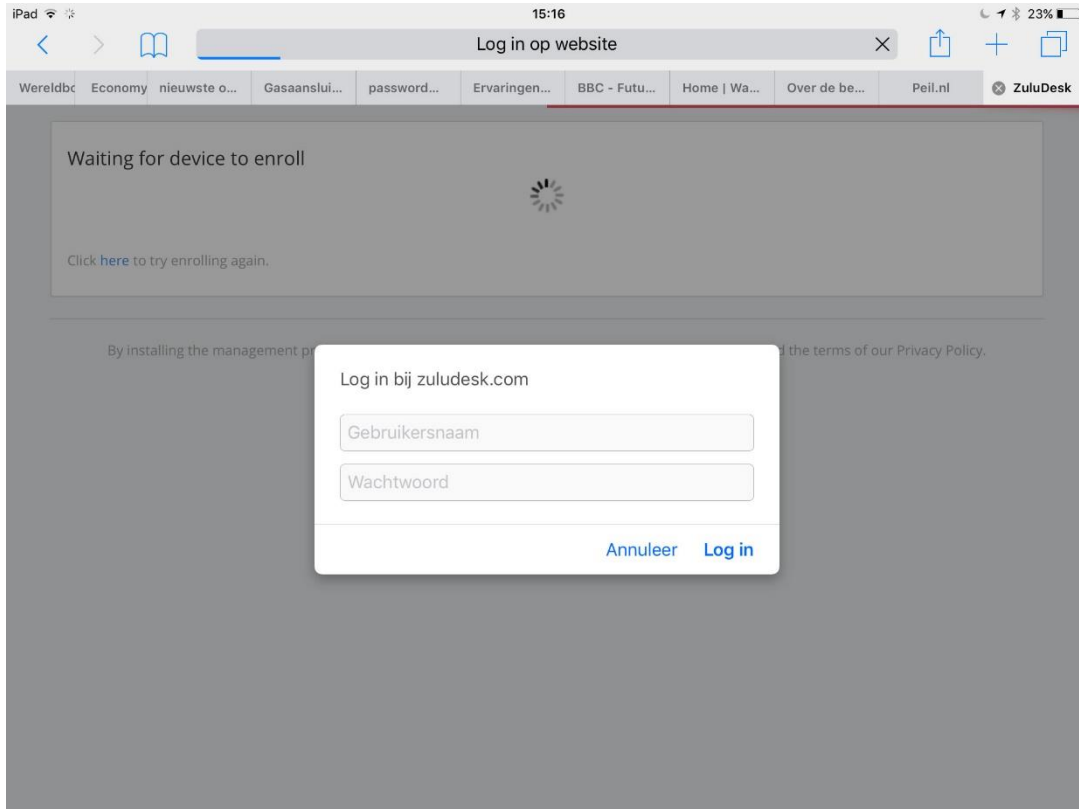

Klik op **Sta toe**

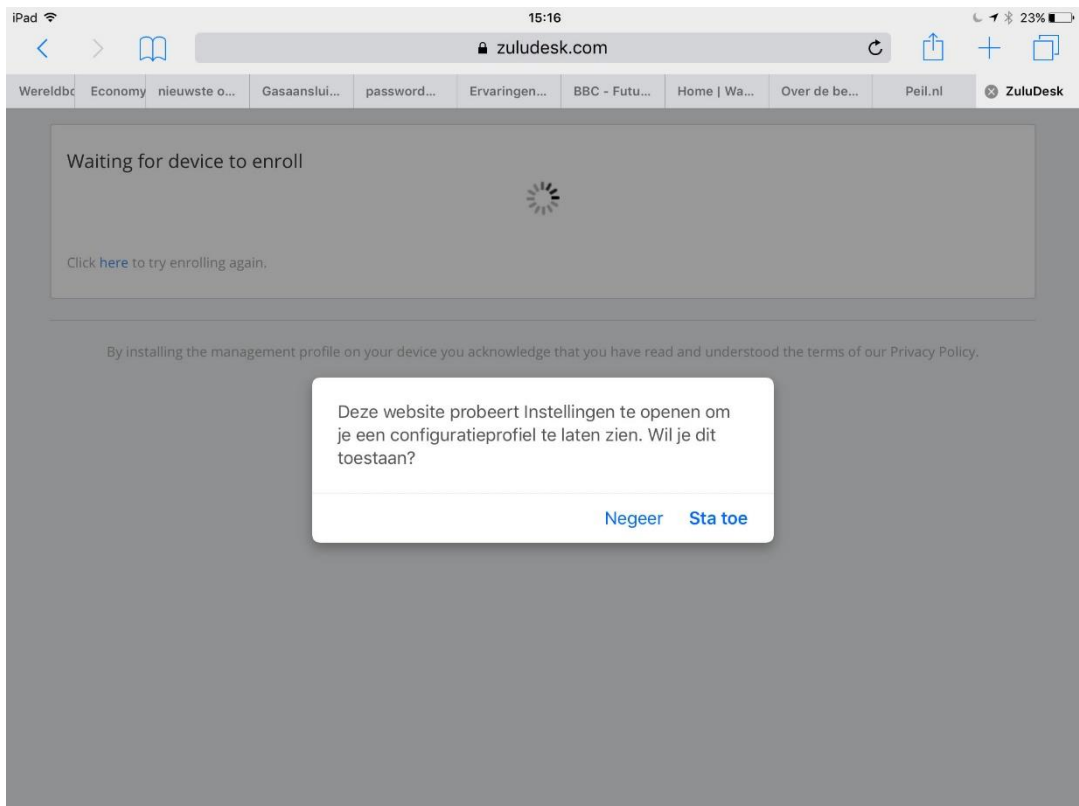

Klik op Installeer

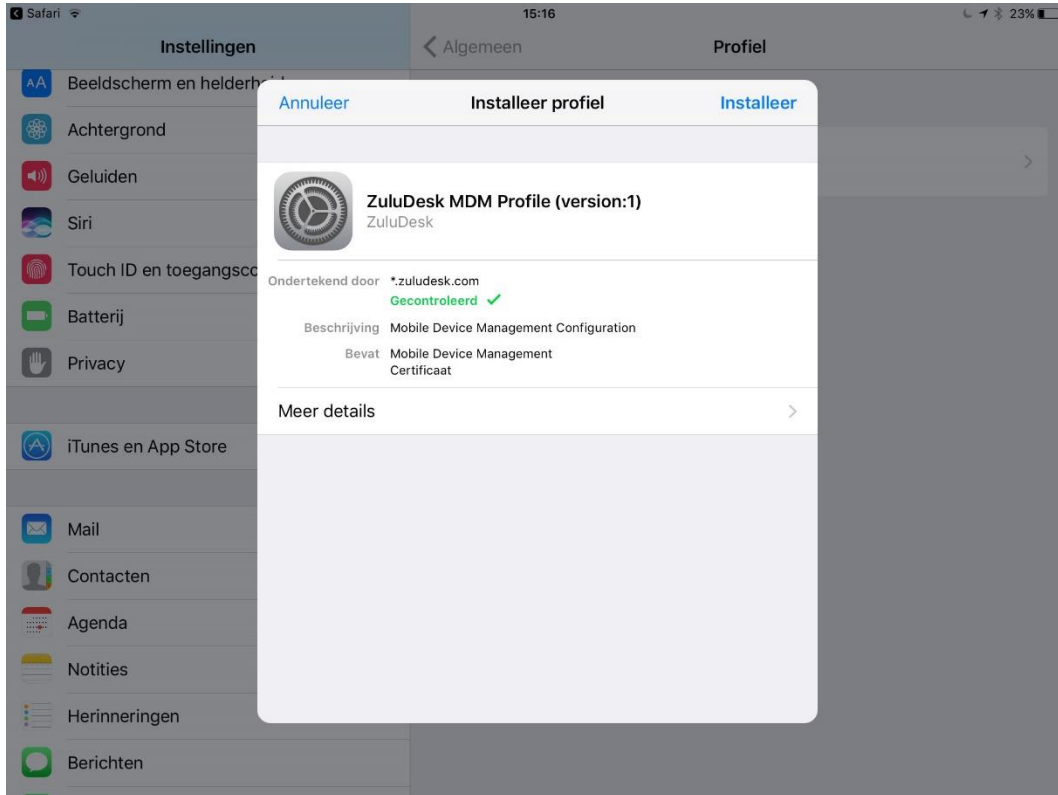

Voer je eigen toegangscode in of autoriseer met je vingerafdruk.

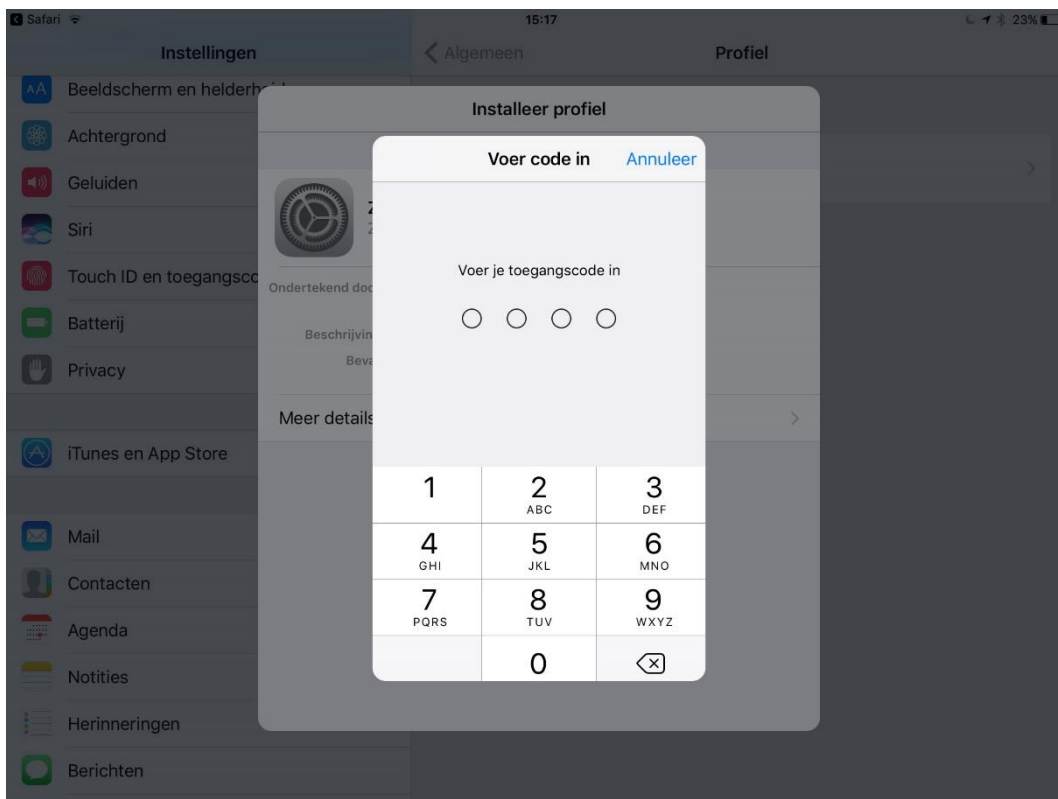

Klik nogmaals op **Installeer**

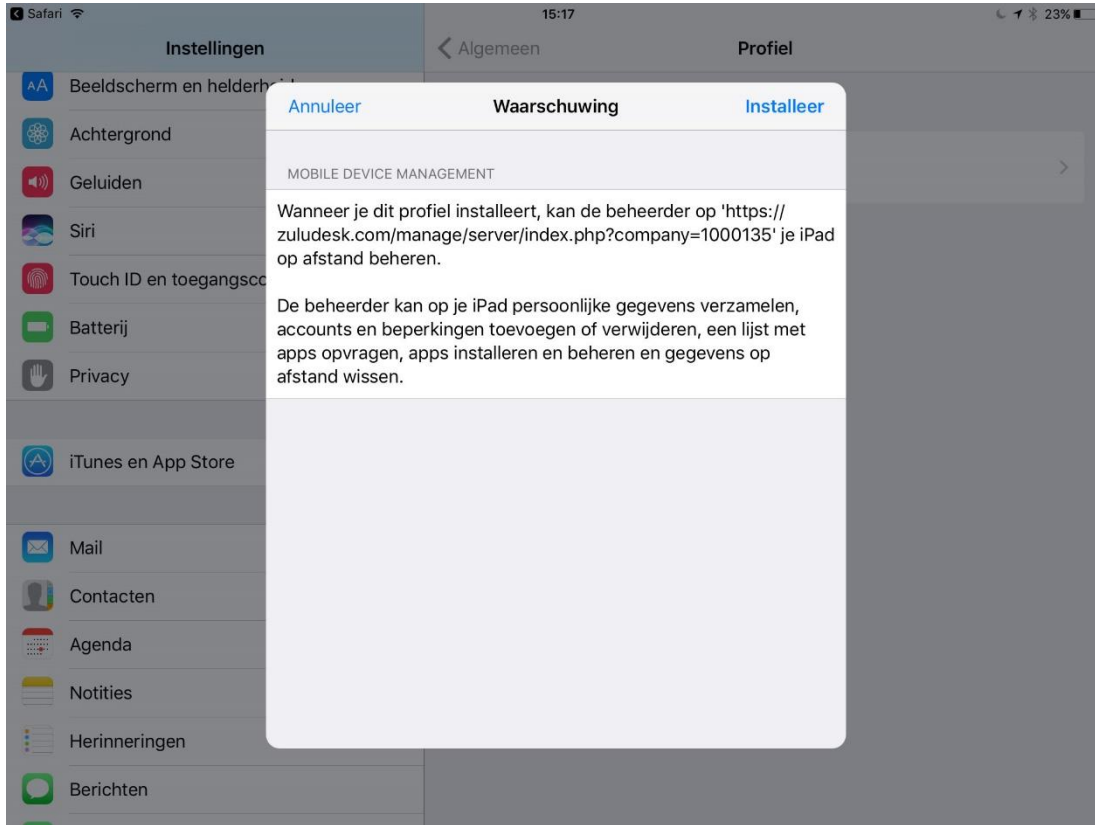

Klik op **Vertrouw**

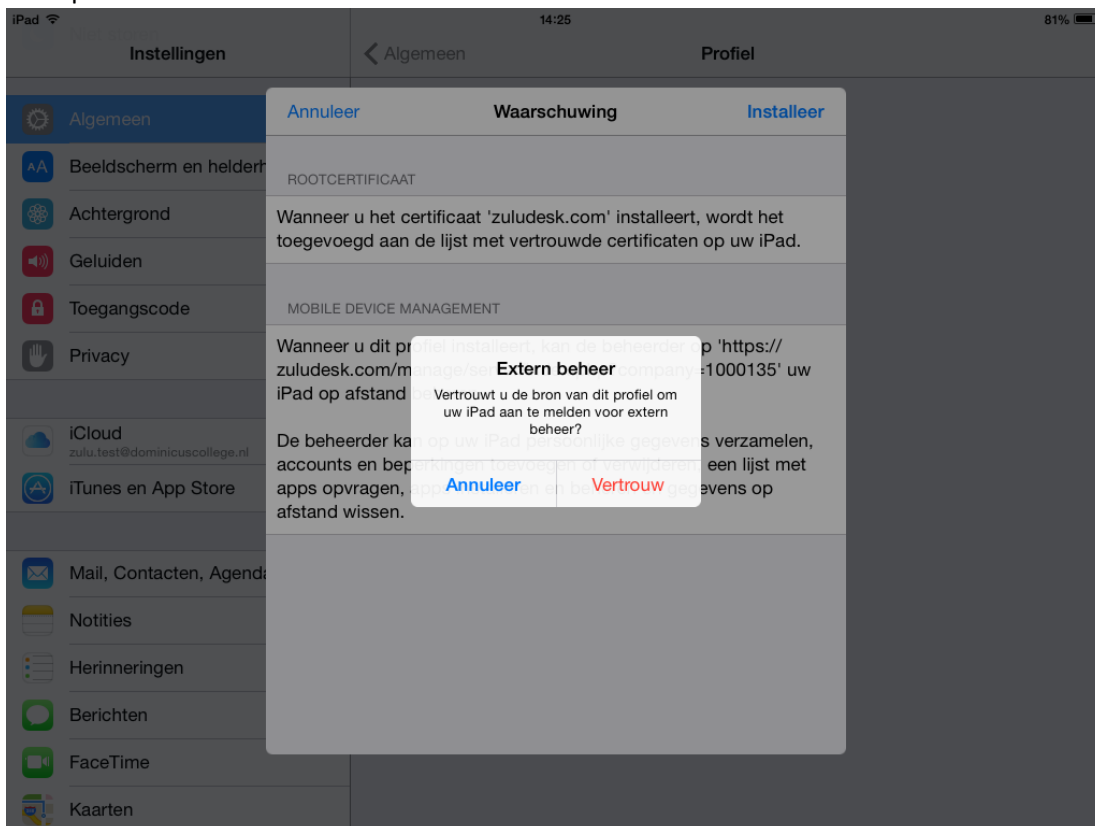

Nadere informatie over extern beheer <https://ipadindeklas.wordpress.com/2016/10/12/het-gebruik-van-zuludesk-op-onze-school-een-toelichting/>

Klik op **Gereed**

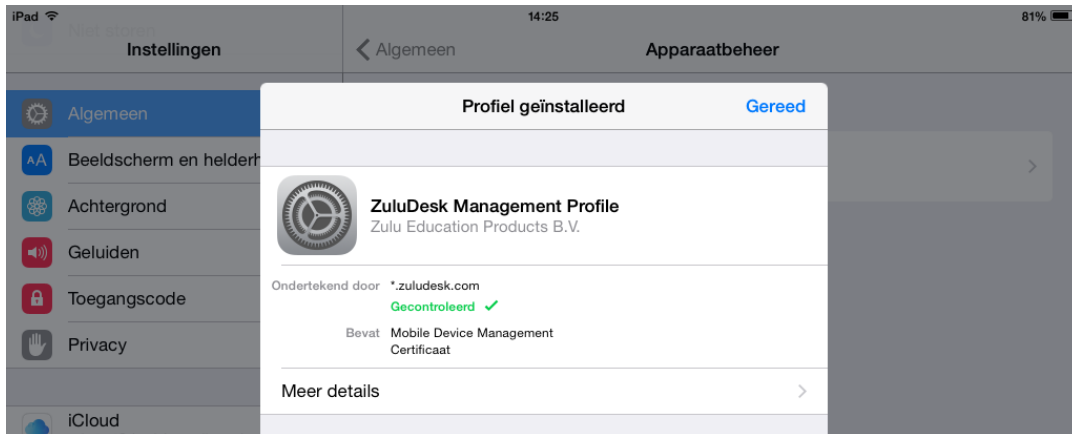

Na onderstaand scherm is je iPad aangemeld in de MDM van het Dominicus College.

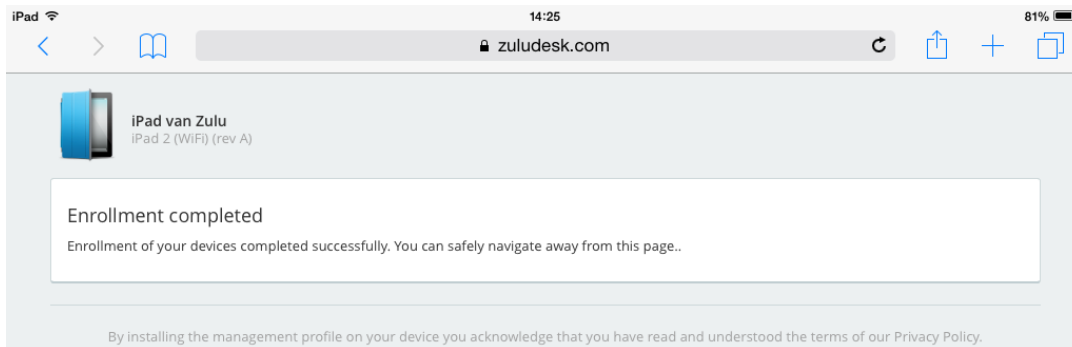

Automatische installatie app Zuludesk Client

Bij onderstaande melding klik dan op **Installeer**

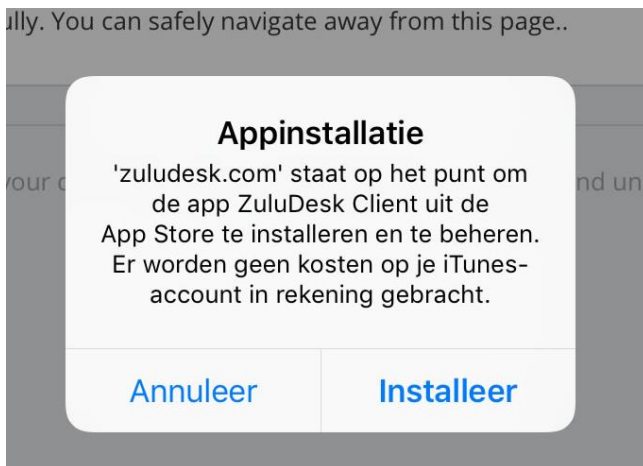

Klik op een van de beginschermen op de app **Zuludesk Client**



Klik bij onderstaande vragen op **Sta toe**. Beide vragen worden niet altijd gesteld.

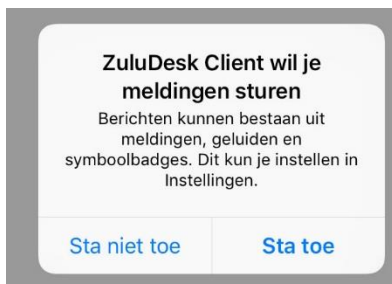

Nu kun je via Zuludesk Client de app's van school installeren.